



## Home Expansion – 8 Spray Can Module

READ General Instructions FIRST!

Sheets: H8C-1 to 4  
& single piece

TIP: Most pieces fit together without glue. Do a test run first, before gluing.



1 the pieces that need to be glued together.

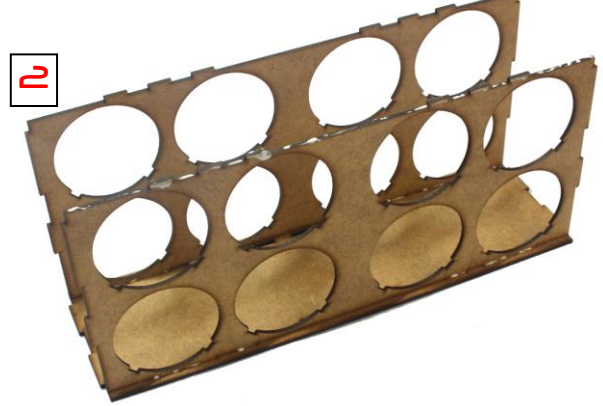

2 first glue in the 2 spray can holders into the slits of the bottom.

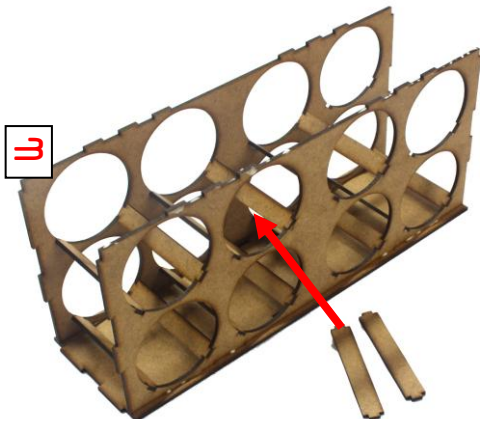

3 glue in all the support strips into the cutouts of the spray can holders.



4 then glue the middle plate and then one side wall (tabs towards the back, where there are other tabs)



5 glue on the other sidewall and the top plate.

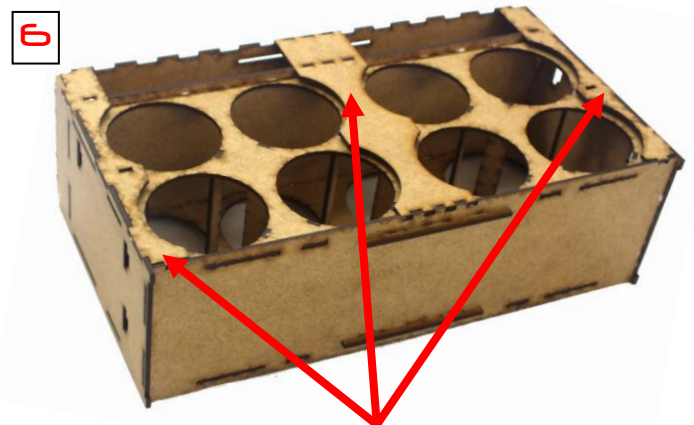

6 glue on the 3 support strips at the back. Ensure right angles. Also glue in the 2 small strips with the 3 tabs into the slits of the bottom from below

Tip: During glue drying use vice grips to ensure right angles / fit.

## Drawer

1

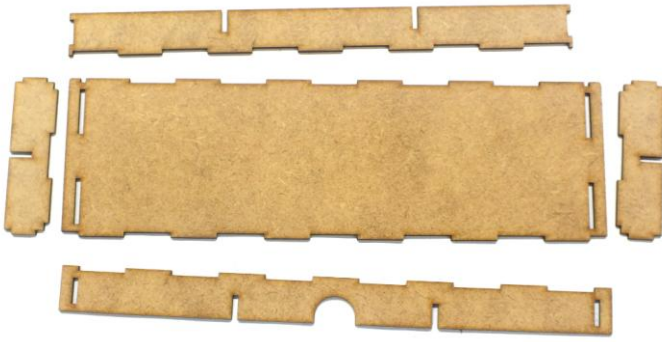

1 the pieces that need to be glued together.

2

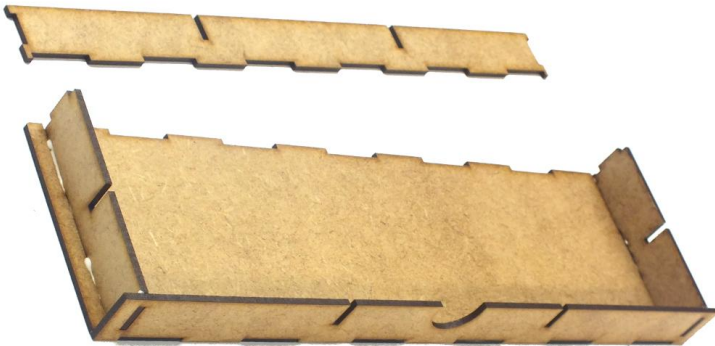

2 first glue in the 2 sidewalls into the slits of the bottom. Then glue in the front wall.

3

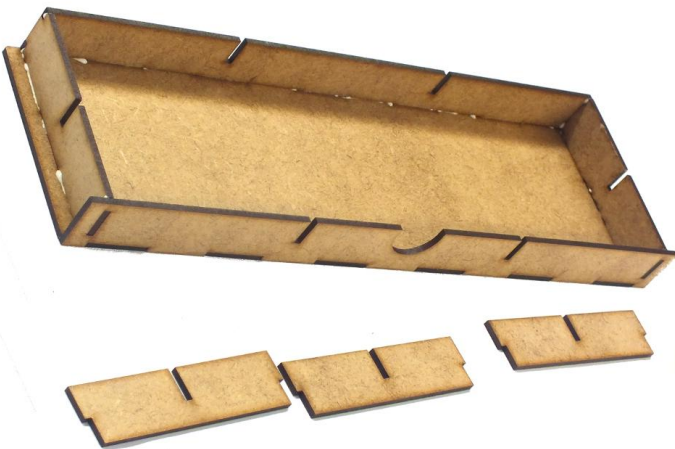

3 glue in the back wall. Ensure right angles.

The dividers can be inserted as needed without glue.